

70

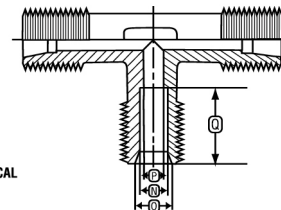
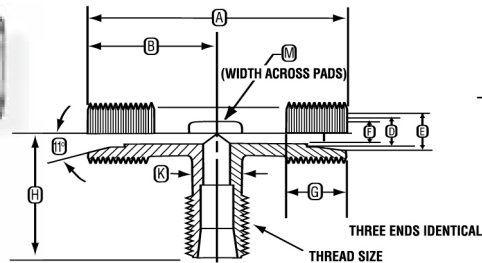
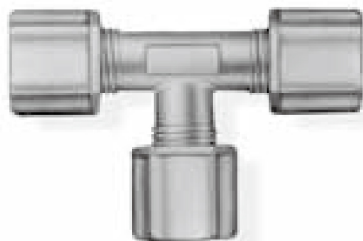

SPECIFICATIONS

JACO Part No.	Tube O.D. 软管 外径	Thread	A	B	D	E	F	G	H	K	M	N	O	P	Q
			± 1/64	± 1/64	.005/ .010		± 1/64	± 1/64	± 1/64	± 1/64	± 1/64	.005/ .010		± .010	± 1/64
70-2	1/8	5/16-24	1-1/8	9/16	.125	.175 - .180	.109	7/16	17/32	1/4	1/4	N/A	N/A	N/A	N/A
70-4	1/4	7/16-20	1-7/16	47/64	.250	.330 - .335	.218	15/32	23/32	3/8	23/64	N/A	N/A	N/A	N/A
70-5	5/16	1/2-20	1-19/32	13/16	.312	.380 - .385	.232	31/64	13/16	7/16	29/64	N/A	N/A	N/A	N/A
70-6	3/8	5/8-20	1-59/64	31/32	.375	.460 - .465	.250	19/32	31/32	35/64	35/64	N/A	N/A	N/A	N/A
70-8	1/2	3/4-20	2-1/8	1-1/16	.500	.590 - .595	.375	11/16	1-1/16	43/64	11/16	N/A	N/A	N/A	N/A
70-10	5/8	7/8-20	2-35/64	1-17/64	.625	.715 - .720	.500	45/64	1-1/4	53/64	53/64	N/A	N/A	N/A	N/A
70-12	3/4	1-1/16-20	3-3/32	1-35/64	.750	.860 - .865	.625	13/16	1-35/64	1	1-1/16	N/A	N/A	N/A	N/A
70-14	7/8	1-3/16-16	3-3/32	1-35/64	.875	.995 - 1.000	.750	7/8	1-35/64	1-1/8	1-3/16	N/A	N/A	N/A	N/A
70-10-6	5/8 - 3/8	7/8-20 - 5/8-20	2-17/32	1-17/64	.625	.715 - .720	.500	45/64	1-9/64	13/16	13/16	.375	.460 - .465	.250	19/32
70-14-10	7/8 - 5/8	1-3/16-16 - 7/8-20	3-3/32	1-35/64	.875	.995 - 1.000	.750	7/8	1-7/16	1-9/64	1-5/32	.625	.715 - .720	.500	45/64
70-14-10-10	7/8 - 5/8	1-3/16-16 - 7/8-20	3-1/64	1-29/64	.875	.995 - 1.000	.500	7/8	1-7/16	1-9/64	1-5/32	.625	.715 - .720	.500	45/64